

UQD08

UQD Series

# Universal Quick Disconnects.

DATA CENTERS

FLUID MANAGEMENT

LIQUID COOLING



## Fluids



Cooling fluids

## Key Benefits



Endurance



Performance



Quality

# FUSO.

# Technical specifications

	Body size		Max operating pressure		Force to connect (0 psi)	Force to connect (100 psi)	Min burst pressure		Rated Flow		Cv Value	Fluid loss per cycle
	(in)	(bar)	(psi)	(N)	(N)	(bar)	(psi)	(lpm)	(gpm)	-	(ml)	
<b>UQD08</b>	1/2	7	101.5	<135	-	20.68	300	17.79	4.7	~4.20	<0.07	

## Construction

### MATERIAL

300 series Stainless steel - 316L

### SEAL MATERIEL

Ethylene-Propylene (EPDM)

### FLOW FOR A SPEED OF 5m/s

27.27 l/min for UQD08

## Hydraulic flow/pressure drop charts

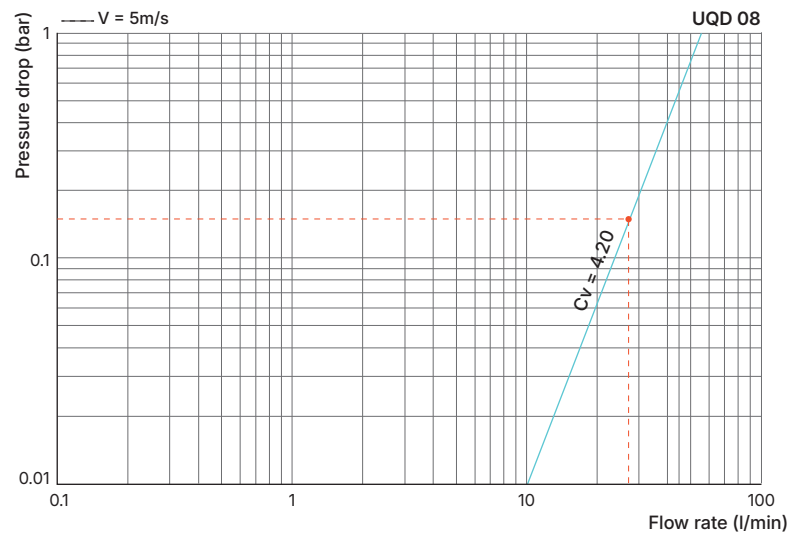

## References

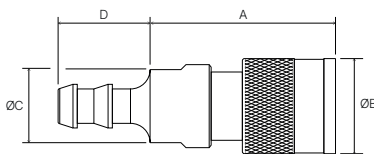

### SOCKET (FEMALE) PART

OCP UQD size	Hose Tail	Dimensions (mm)				Part Reference
		A	B	C	D	
UQD08	5/8" HB	64.81	35	27	23.82	UQD08-SB UQD08-SR

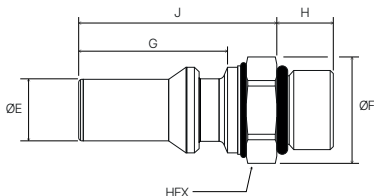

### PLUG (MALE) PART

OCP UQD size	ORB	Dimensions (mm)						Part Reference
		E	F	G	H	J	Hex	
UQD08	7/8-14 UNF-2A ORB-10	17.48	30	34	12.7	42.9	27	UQD08-PB UQD08-PR

